

Go to www.vtechphones.com to register your product for enhanced warranty support and the latest VTech product news.

VM5251
VM5251-2

Full Color Video Monitor



vtech
User's manual

CONGRATULATIONS

on purchasing your new VTech product. Before using this product, please read **Important safety instructions**.

This manual has all the feature operations and troubleshooting necessary to install and operate your new VTech product. Please review this manual thoroughly to ensure proper installation and operation of this innovative and feature-rich VTech product.

For support, shopping, and everything new at VTech, visit our website at www.vtechphones.com.

WHAT'S IN THE BOX

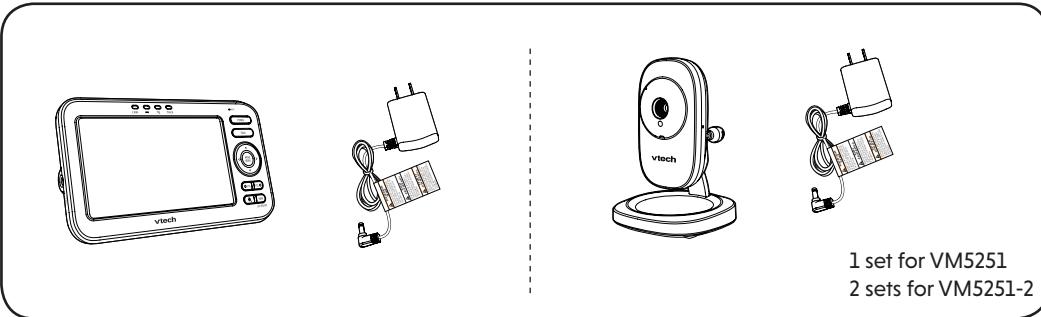

IMPORTANT SAFETY INSTRUCTIONS

The applied nameplate is located at the bottom of the baby unit's base. When using your equipment, basic safety precautions should always be followed to reduce the risk of fire, electric shock and injury, including the following:

- Follow all warnings and instructions marked on the product.
- Adult setup is required.
- CAUTION:** Do not install the baby unit at a height above 2 meters.
- This product is not a substitute for adult supervision of the infant. Supervising the infant is the parent's or caregiver's responsibility. This product could cease operating, and therefore you should not assume it will continue working properly for any given period of time. Further, this is not a medical device and should not be used as such. This product is intended to assist you in supervising your baby.
- Do not use this product near water. For example, do not use it next to a bath tub, wash bowl, kitchen sink, laundry tub or swimming pool, or in a wet basement or shower.

CAUTION: Use only the battery provided. There may be a risk of explosion if a wrong type of battery is used for the parent unit. The battery cannot be subjected to high or low extreme temperature and low air pressure at high altitude during use, storage or transportation. Disposal of battery into fire or a hot oven, or mechanically crushing or cutting or the battery can result in an explosion. Leaving the battery in an extremely high temperature surrounding environment can result in an explosion or the leakage of flammable liquid or gas. Battery subjected to extremely low air pressure may result in an explosion or the leakage of flammable liquid or gas. Dispose of used battery according to the information in **The RRC seal**.

Use only the adapters included with this product. Incorrect adapter polarity or voltage can seriously damage the product. Baby unit power adapter: Output: 5V DC 1A; Parent unit power adapter: Output: 5V DC 1A.

The power adapters are intended to be correctly oriented in a vertical or floor mount position. The prongs are not designed to hold the plug in place if it is plugged into a ceiling, under-the-table or cabinet outlet.

For pluggable equipment, the socket-outlet shall be installed near the equipment and shall be easily accessible.

Unplug this product from the wall outlet before cleaning. Do not use liquid or aerosol cleaners. Use a damp cloth for cleaning.

Do not cut off the power adapters to replace them with other plugs, as this causes a hazardous situation.

Do not allow anything to rest on the power cords. Do not install this product where the cords may be walked on or crimped.

This product should only be operated only from the type of power source indicated on the marking label. If you are not sure of the type of power supply in your home, consult your dealer or local power company.

Do not overload wall outlets or use an extension cord.

Do not place this product on an unstable table, shelf, stand or other unstable surfaces.

This product should not be placed in any area where proper ventilation is not provided. Slots and openings in the back or bottom of this product are provided for ventilation. To protect them from overheating, these openings must not be blocked by placing the product on a soft surface such as a bed, sofa or rug. This product should never be placed near or over a radiator or heat register.

Never push objects of any kind into this product through the slots because they may touch dangerous voltage points or create a short circuit. Never spill liquid of any kind on the product.

To reduce the risk of electric shock, do not disassemble this product, but take it to an authorized service facility. Opening or removing parts of the product other than specified access doors may expose you to dangerous voltages or other risks. Incorrect reassembling can cause electric shock when the product is subsequently used.

You should test the sound reception every time you turn on the units or move one of the components.

Periodically examine all components for damage.

There is a very low risk of privacy loss when using certain electronic devices, such as baby monitors, cordless telephones, etc. To protect your privacy, make sure the product has never been used before purchase, reset the baby monitor periodically by powering off and then powering on the units, and power off the baby monitor if you will not use it for some time.

Children should be supervised to ensure that they do not play with the product.

The product is not intended for use by persons (including children) with reduced physical, sensory or mental capabilities, or lack of experience and knowledge, unless they have been given supervision or instruction concerning use of the appliance by a person responsible for their safety.

SAVE THESE INSTRUCTIONS

- Cautions**
- Use and store the product at a temperature between 32°F and 104°F.
 - Do not expose the product to extreme cold, heat or direct sunlight. Do not put the product close to a heating source.
 - Batteries should not be exposed to excessive heat such as bright sunshine or fire.
 - Warning—Strangulation Hazard—**Children have STRANGLED in cords. Keep this cord out of the reach of children (more than 3 ft (0.9m) away). Do not remove this tag.
 - Never place the baby unit(s) inside the baby's crib or playpen. Never cover the baby unit(s) or parent unit with anything such as a towel or a blanket.
 - Other electronic products may cause interference with your baby monitor. Try installing your baby monitor as far away from these electronic devices as possible: wireless routers, radios, cellular telephones, intercoms, room monitors, televisions, personal computers, kitchen appliances and cordless telephones.

Precautions for users of implanted cardiac pacemakers

Cardiac pacemakers (applies only to digital cordless devices): Wireless Technology Research, LLC (WTR), an independent research entity, led a multidisciplinary evaluation of the interference between portable wireless devices and implanted cardiac pacemakers. Supported by the U.S. Food and Drug Administration, WTR recommends to physicians that:

Pacemaker patients

- Should keep wireless devices at least six inches from the pacemaker.
- Should NOT place wireless devices directly over the pacemaker, such as in a breast pocket, when it is turned ON. WTR's evaluation did not identify any risk to bystanders with pacemakers from other persons using wireless devices.

Electromagnetic fields (EMF)

This VTech product complies with all standards regarding electromagnetic fields (EMF). If handled properly and according to the instructions in this user's manual, the product is safe to be used based on scientific evidence available today.

1 CONNECT AND CHARGE THE BATTERY

Connect the baby monitor

NOTES

- The rechargeable battery in the parent unit is built-in.
- Use only the power adapters supplied with this product.
- Make sure the baby monitor is not connected to a switch-controlled electric outlet.
- Connect the power adapters in a vertical or floor mount position only. The adapters' prongs are not designed to hold the weight of baby monitor, so do not connect them to any ceiling, under-the-table, or cabinet outlets. Otherwise, the adapters may not properly connect to the outlets.
- Make sure the parent unit, the baby unit and the power adapter cords are out of reach of children.

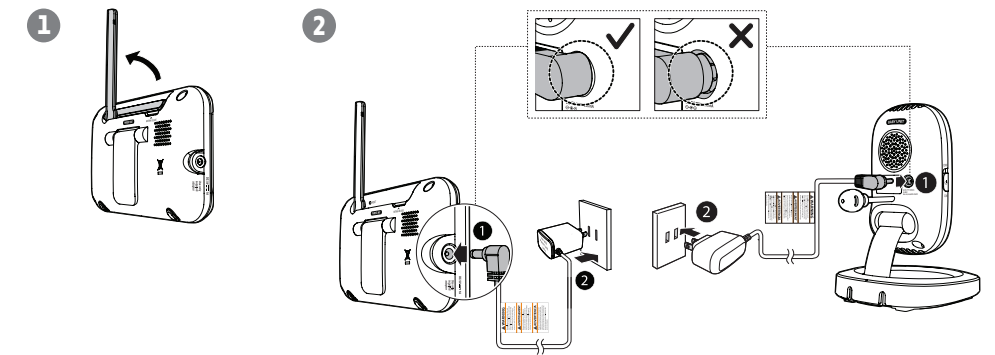



Charge the parent unit battery

When you have connected the parent unit and installed its battery for the first time or after power outage, the parent unit powers on automatically. The battery icon indicates the battery status (see the following table).

NOTES

- Before using the baby monitor for the first time, charge the parent unit battery for 12 hours. When the parent unit battery is fully charged, the battery icon becomes solid .
- It takes longer to charge the battery when the parent unit is turned on. To shorten the charging time, turn the parent unit off while charging.
- The standby time varies depending on the sensitivity level you set, your actual use and the age of the battery.

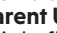
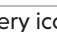
| BATTERY INDICATORS | BATTERY STATUS | ACTION |
|--|---|--|
| The screen displays  Battery low at Parent Unit and  . The  light flashes. | The battery has very little charge and may be used for only a short time. | Charge without interruption (about 30 minutes). |
| The battery icon becomes solid  . | The battery is fully charged. | To keep the battery charged, connect it to AC power when not in use. |

2 BEFORE USE

NOTE

- This baby monitor is intended as an aid. It is not a substitute for proper adult supervision, and should not be used as such.

Test your baby monitor

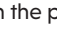

You may test the baby monitor before initial use, and at regular times thereafter.

CAUTION

- For hearing protection, make sure the parent unit is more than 3 feet (1 meter) away from both baby units. If you hear any high-pitched noise, move the parent unit further until the noise stops. You can also press  on the parent unit to reduce the noise.

- Make sure your baby unit and parent unit are on.
- The parent unit displays images from the baby unit.
 - Speak towards the microphone of the baby unit. You will hear the sound at the parent unit.
- If you have two baby units, press **VIEW** on your parent unit. The screen switches to the other baby unit. Then, repeat step 2.

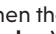
NOTE

- When the parent unit displays  and then  **No Link to CAM # (# represents the baby unit number)**, and the **LINK** LED light flashes, move the parent unit closer to the baby unit (observe the minimum distance of 3 feet / 1 meter). You can also check if the baby unit is connected to a live power socket and switched on.

TIP

- Increase the speaker volume of the parent unit if you cannot hear the sounds transmitted from the baby units.

Positioning the baby monitor

CAUTION

- Keep the baby unit out of the reach of your baby. Never place or mount the baby unit inside the baby's crib or playpen.

NOTE

- To avoid interference from other electronic devices, place your baby monitor at least 3 feet (1 meter) away from devices such as wireless routers, microwaves, cell phones and computers.

- Place the baby unit more than 3 feet (1 meter) away from your baby.
- Adjust the angle of the baby unit camera to aim at your baby.
- Bend down the temperature sensor so that it stays away from baby unit to avoid deviation of temperature detection.
- Place the parent unit more than 3 feet (1 meter) away from the baby units to avoid screaming noise.

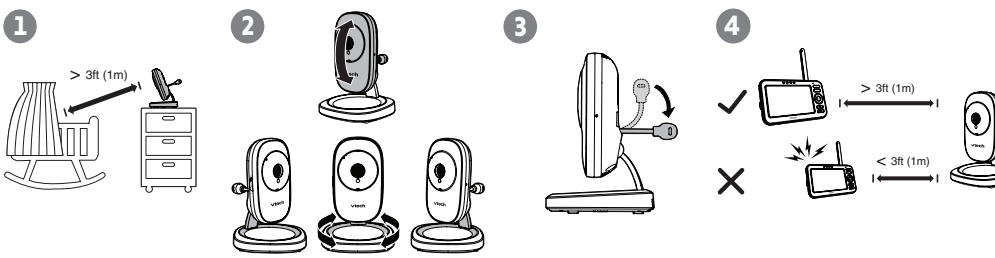

CAUTION

- The default volume of your parent unit is level 4, and the maximum volume is level 7. If you experience high-pitched screaming noise from your baby monitor while positioning:
 - Make sure your baby unit and parent unit are more than 3 feet (1 meter) apart, OR
 - Lower the volume of your parent unit.

Operating range

The operating range of the baby monitor is up to 1000 feet (300 meters) outdoors. The actual operating range may vary depending on the environmental conditions and other interferences such as walls, doors and other obstructions.

3 USING THE BABY MONITOR

Power on or off the baby unit

- Slide the **ON/OFF** switch to **ON** to turn on the baby unit. The **ON/OFF** LED light turns on.
- Slide the **ON/OFF** switch to **OFF** to turn off the baby unit. The **ON/OFF** LED light turns off.

Power on or off the parent unit

- Press and hold **POWER** to turn on the parent unit. The screen turns on.
- Press and hold **POWER** again to turn off the parent unit. The screen turns off.

Turn on or off the parent unit screen

You can turn on or off the parent unit screen without powering off the parent unit. You can still hear sound from the baby units.

- Press and hold **LCD ON/OFF** on the parent unit to turn off the screen.
- Press any keys on the parent unit to turn on the screen again.

Adjust speaker volume

For parent unit:

- Press **VOL +** or **VOL -** on the parent unit at any time when viewing images.

For baby unit:

The baby unit speaker volume determines the lullaby volume and talkback volume transmitted from parent unit. It can be adjusted in the parent unit.

- Press **MENU** when the parent unit is idle.
- Press **V** or **A** to choose **Volume on CAM**, then press **SELECT**.
- Press **V** or **A** to choose the desired volume level. Level 1 is the softest while Level 5 is the loudest. Then, press **SELECT** to confirm your selection.

NOTE

- Volume adjustment with the parent unit menu is available in **Single CAM** and **Patrol** mode only.

3 USING THE BABY MONITOR (CON'T)

Lullaby

The baby monitor has five lullabies and four soothing sounds for you to comfort your baby. You can play lullabies or soothing sounds on the baby unit by controlling remotely with the parent unit.

To play lullabies:

- Press **MENU** when the parent unit is idle.
- Press **V** or **A** to choose **Lullaby on CAM**, then press **SELECT**.
- Press **V** or **A** to choose **Play Melodies**, then press **SELECT**.
- Press **V** or **A** to choose a lullaby, or choose **Play All**, then press **SELECT**.
 - If **Play All** is selected, the five lullabies will be played one after the other, until all of them are played.
- When the desired lullaby is selected, press **V** or **A** to choose **Play**, then press **SELECT**.

To play soothing sounds:

- Press **MENU** when the parent unit is idle.
- Press **V** or **A** to choose **Lullaby on CAM**, then press **SELECT**.
- Press **V** or **A** to choose **Play Soothing Sounds**, then press **SELECT**.
- Press **V** or **A** to choose a soothing sound, then press **SELECT**.
- Press **V** or **A** to choose **Play**, then press **SELECT**.

NOTES

- Lullaby playback control is available in **Single CAM** and **Patrol** mode only.
- The lullaby playback on the baby unit will be paused when receiving talkback from the parent unit.

To stop lullabies or soothing sounds:

- Press **MENU** when the parent unit is idle.
- Press **V** or **A** to choose **Lullaby on CAM**, then press **SELECT**.
- Press **V** or **A** to choose **Stop**, then press **SELECT**.

To set auto timer for lullabies:

While the baby unit is playing a lullaby or soothing sound, the auto timer feature automatically stops the lullaby or soothing sound after playing for 15/30/45/60 minutes. You can set auto timer for lullabies with the parent unit.

- Press **MENU** when the parent unit is idle.
- Press **V** or **A** to choose **Lullaby on CAM**, then press **SELECT**.
- Press **V** or **A** to choose **Auto Timer**, then press **SELECT**.
- Press **V** or **A** to choose the desired lullabies duration, then press **SELECT** to confirm your selection.

After 15/30/45/60 minutes, the lullaby or soothing sound will stop automatically.

Set the language

You can select a language (English, French or Spanish) to be used in all screen displays.

- Press **MENU** when the parent unit is idle.
- Press **V** or **A** to choose **Language**, then press **SELECT**.
- Press **V** or **A** to choose **English**, **Français** or **Español**, then press **SELECT** to confirm your selection.

Adjust LCD brightness

You can change the brightness of the parent unit screen from **Level 1** to **Level 5**. The LCD brightness is preset to **Level 3**.

- Press **MENU** when the parent unit is idle.
- Press **V** or **A** to choose **LCD**, then press **SELECT**.
- Press **SELECT** again to choose **Brightness**.
- Press **V** or **A** to choose the desired level of brightness, then press **SELECT** to confirm your selection.

Turn on and off the dim mode

The dim mode is preset to on to help you save the parent unit power. Your parent unit display will dim automatically after 10 minutes of inactivity, in which there is neither key pressed nor alert received from the baby unit.

- Press **MENU** when the parent unit is idle.
- Press **V** or **A** to choose **LCD**, then press **SELECT**.
- Press **V** or **A** to choose **Dim mode**, then press **SELECT**.
- Press **V** or **A** to choose **On** or **Off**, then press **SELECT** to confirm your selection.

NOTE

- While the screen is dimmed, any keypress or alert message will trigger the screen to return to the preset brightness level. After 10 minutes of inactivity, it will dim again.

Monitoring mode * for VM5251-2 only

Every time the parent unit is turned on, it displays a baby unit in **Single CAM** mode. If there are two baby units in your system, you can also monitor your baby in **Patrol** or **Split** mode.

| | |
|-------------------|---|
| Single CAM | The screen displays image of a single baby unit in full screen. |
| Patrol | A single cam view that transitions to a different baby unit every 10 seconds. |
| Split | The screen displays all baby units. |

You can choose the desired monitoring mode.

- Press **MENU** when the parent unit is idle.
- Press **V** or **A** to choose **Monitoring Mode**, then press **SELECT**.
- Press **V** or **A** to choose **Single CAM**, **Patrol** or **Split**, then press **SELECT**.

In Single CAM or Patrol mode:

- Press **VIEW** to view the next baby unit.

In Split mode:

- Press **<** or **>** to select a baby unit.
 - Press **Q** or **VIEW** to view the selected baby unit temporarily in **Single CAM** mode. It returns to **Split** mode after 10 seconds.
- #### NOTE
- If the volume of the parent unit is not muted:
 - In **Single CAM** or **Patrol** mode, you hear the sound from the baby unit being viewed.
 - In **Split** mode, you hear the sound from the selected baby unit.

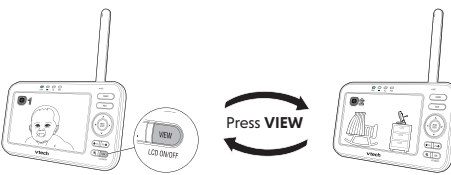

Adjust the sound sensitivity of the baby unit

You can choose to hear sounds from the baby unit all the time, or to hear sounds that exceed a certain level. You can use the parent unit to adjust the microphone sensitivity of your baby unit. The higher the sensitivity level, the more sensitive the baby unit is in detecting sounds for transmitting to the parent unit. The VOX sensitivity level is preset to **HIGHEST**.

| VOX SENSITIVITY LEVEL | Highest | High | Medium | Low | Lowest |
|-----------------------|---|--|---|--|---|
| DESCRIPTION | The parent unit speaker is constantly on, and you will hear all sounds (including background noises) from your baby's room. | The parent unit speaker turns on for soft babbling and louder sounds from your baby. It remains quiet when your baby sleeps soundly. | The parent unit speaker turns on for loud babbling and louder sounds from your baby. It remains quiet when your baby makes soft sounds. | The parent unit speaker turns on for crying and louder sounds from your baby. It remains quiet when your baby makes soft sounds. | The parent unit speaker turns on for loud crying or screaming sounds from your baby. It remains quiet when your baby makes soft sounds. |

- Press **MENU** when the parent unit is idle.
- Press **V** or **A** to choose **VOX Sensitivity**, then press **SELECT**.
 - If you have two baby units, the system prompts you to choose the desired baby unit or both baby units, press **V** or **A** to choose **ALL CAM** or **CAM #**, then press **SELECT**.
- Press **V** or **A** to choose the desired sensitivity level, then press **SELECT** to confirm your selection.

NOTE

- As long as the **Sound-activated Screen** setting is **On**, the screen will turn on automatically when VOX sensitivity is triggered, despite it was off earlier.

TIPS

- You can adjust the baby unit placement to improve the sound detection.
- If you want to use a sound machine or white noise machine for natural white noise while using this baby monitor to check on your baby, you can:
 - Lower the volume of your sound machine or white noise machine; or
 - Lower the sensitivity level of your baby monitor to medium (level 3) or below. Default level is the highest level.

Turn on or off the sound activation

When sound activation is on, as long as no sound is detected within 50 seconds, the parent unit screen will turn off automatically to save power.

When your baby unit detects a sound, which exceeds the selected sensitivity level, the sound activation triggers the parent unit screen to turn on automatically. When no sound is detected within 50 seconds, the screen will be off again.

- Press **MENU** when the parent unit is idle.
- Press **V** or **A** to choose **Sound-activated Screen**, then press **SELECT**.
- Press **V** or **A** to choose **On** or **Off**, then press **SELECT** to confirm your selection. The screen returns to main menu.

Sound alert in split-view

You can turn on the sound alert feature so that, while in **Split** mode, the parent unit beeps and displays **Sound detected at CAM #** whenever the baby unit detects sounds.

- Press **MENU** when the parent unit is idle.
- Press **V** or **A** to choose **Alert Tone**, then press **SELECT**.
- Press **V** or **A** to choose **Sound Alert in Split-view**, then press **SELECT**.
- Press **V** or **A** to choose **On** or **Off**, then press **SELECT** to confirm your selection.

3 USING THE BABY MONITOR (CON'T)

NOTE

The sound alert feature is only available in **Split** mode.

Monitor the temperature

Your baby unit monitors the temperature of your baby's room with its built-in temperature sensor. If the detected temperature is out of the preset temperature range, the parent unit will display an alert message.

Set temperature range

You can set the desired room temperature alert range. The minimum temperature can be set between **52 °F (11 °C)** and **69 °F (20 °C)**. The maximum temperature can be set between **70 °F (21 °C)** and **86 °F (30 °C)**.

- Press **MENU** when the parent unit is idle.
- Press **▼** or **▲** to choose **Temperature**, then press **SELECT**.
- Press **▼** or **▲** to choose **Minimum** or **Maximum**, then press **SELECT**.
 - If you have two baby units, the system prompts you to choose the desired baby unit or both baby units, press **▼** or **▲** to choose **ALL CAM** or **CAM #**, then press **SELECT**.
- Press **▼** or **▲** to choose the desired minimum or maximum temperature, then press **SELECT** to confirm your selection.

Temperature alert tone

You can turn on the temperature alert tone so that the parent unit will emit an alert tone if the detected temperature is out of range.

- Press **MENU** when the parent unit is idle.
- Press **▼** or **▲** to choose **Temperature**, then press **SELECT**.
- Press **▼** or **▲** to choose **Alert tone**, then press **SELECT**.
 - If you have two baby units, the system prompts you to choose the desired baby unit or both baby units, press **▼** or **▲** to choose **ALL CAM** or **CAM #**, then press **SELECT**.
- Press **▼** or **▲** to choose **On** or **Off**, then press **SELECT** to confirm your selection.

Temperature format

You can choose to display the temperature in Fahrenheit (°F) or Celsius (°C).

- Press **MENU** when the parent unit is idle.
- Press **▼** or **▲** to choose **Temperature**, then press **SELECT**.
- Press **▼** or **▲** to choose **Format**, then press **SELECT**.
- Press **▼** or **▲** to choose **°F** or **°C**, then press **SELECT** to confirm your selection.

Rename the baby unit

You can rename the baby unit. Once the baby unit is renamed, its new name together with the baby unit number will appear in the sub-menu of below options:

- VOX Sensitivity
- Rename
- Temperature

- Press **MENU** when the parent unit is idle.
- Press **▼** or **▲** to choose **Rename**, then press **SELECT**.
- Press **▼** or **▲** to choose the desired baby unit, then press **SELECT**.
- Press **▼** or **▲** to choose the desired name for the baby unit, then press **SELECT** to confirm your selection.

BABY UNIT OVERVIEW

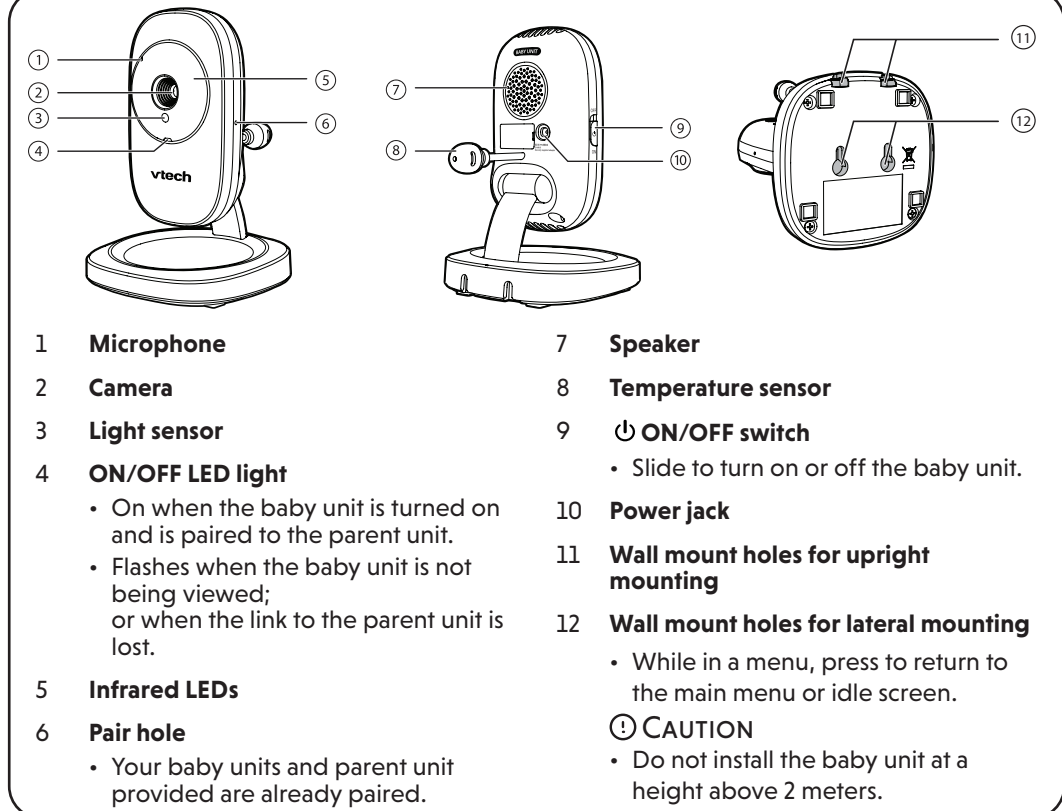

PARENT UNIT OVERVIEW

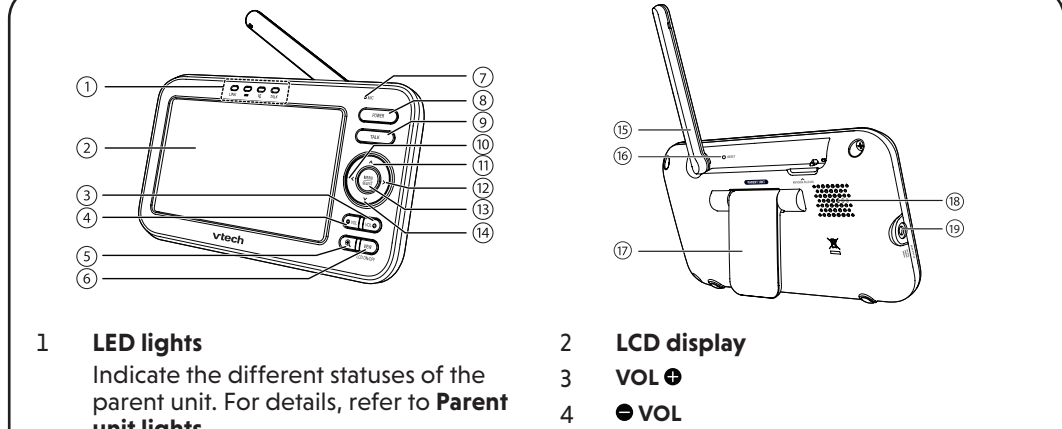

PARENT UNIT OVERVIEW (CON'T)

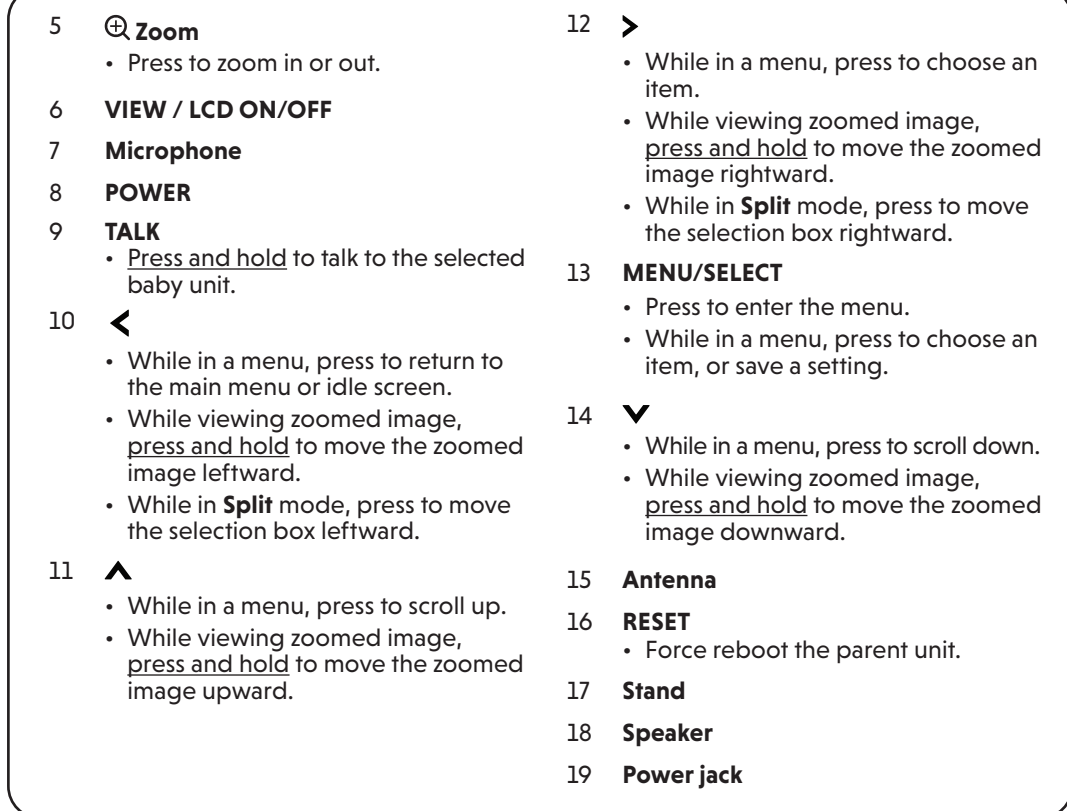

PARENT UNIT LIGHTS

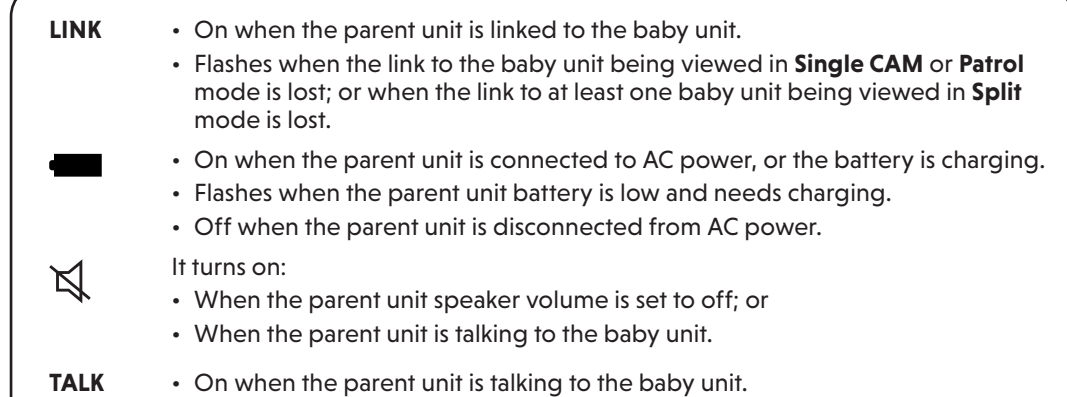

PARENT UNIT ICONS

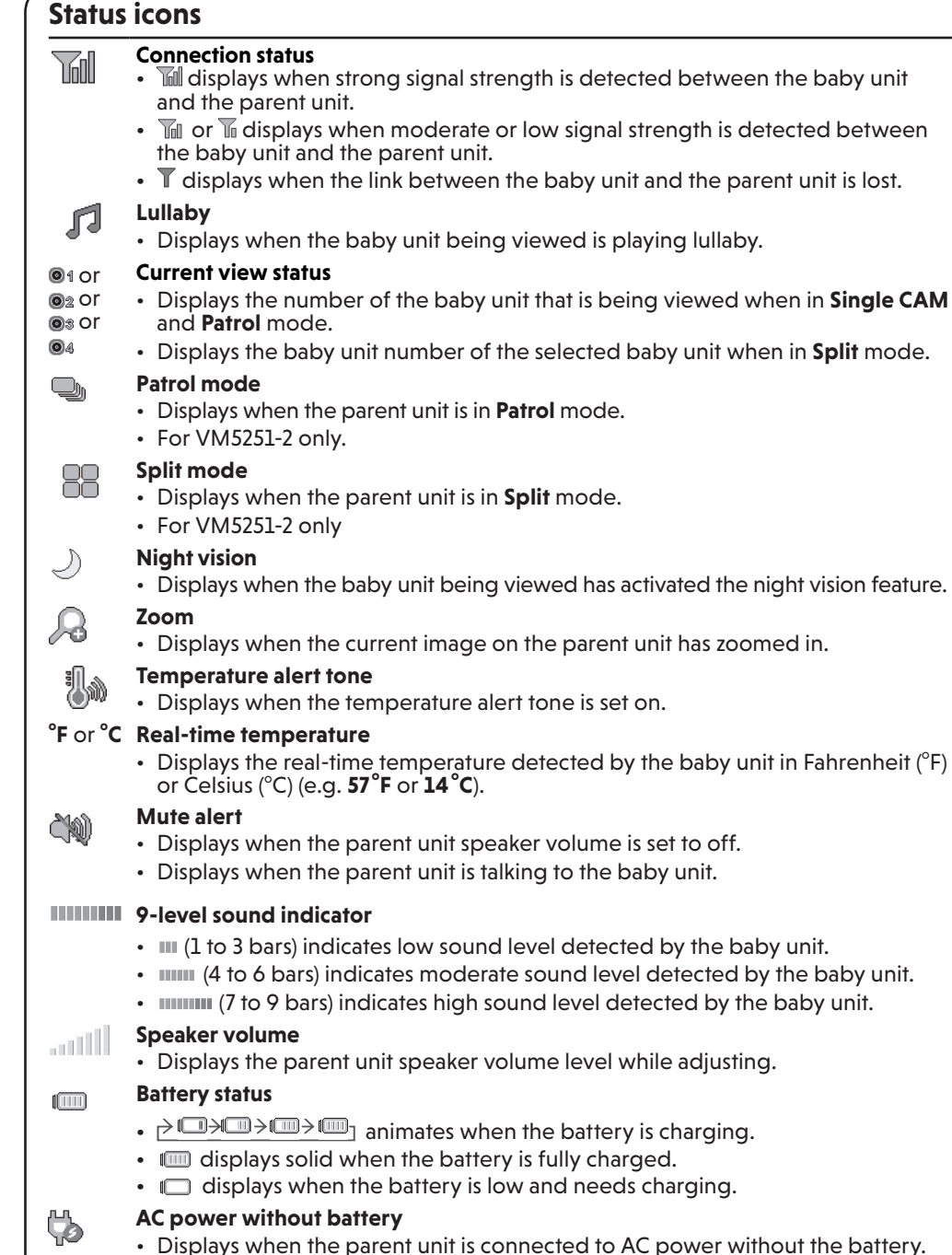

Main menu icons

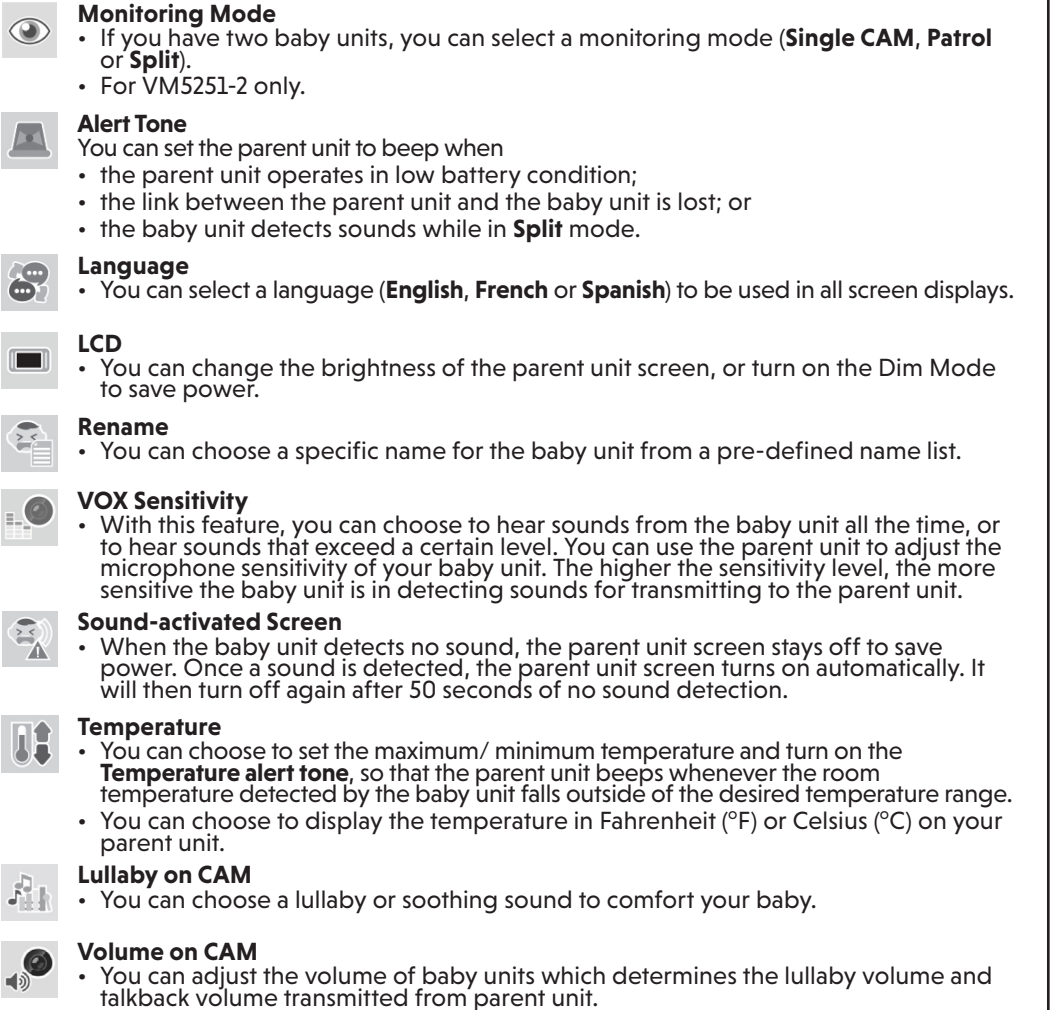

Warning icons and messages

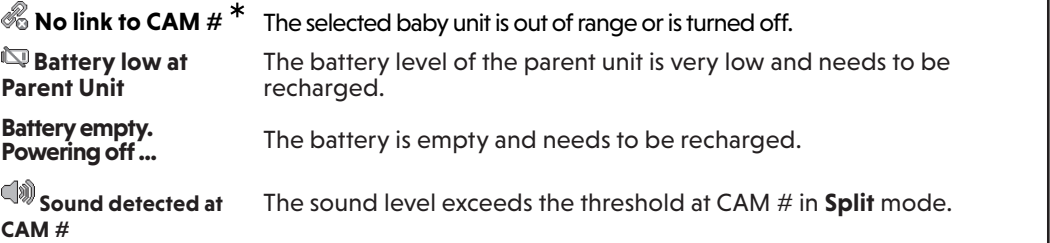

PARENT UNIT ICONS (CON'T)

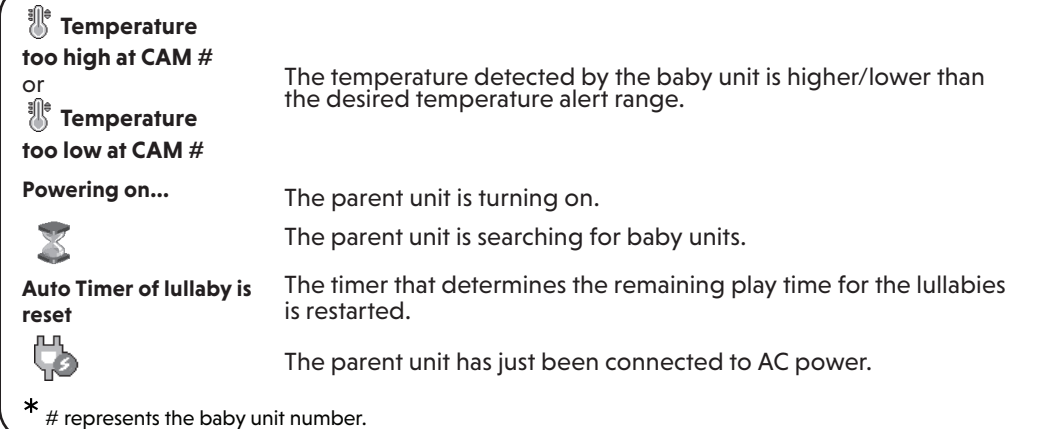

NIGHT VISION

The baby unit has infrared LEDs that allow you to see your baby clearly at night or in a dark room. When the baby unit being viewed detects low light levels, the infrared LEDs are switched on automatically. The images from the baby unit are in black and white, and appears on the screen.

NOTES

- It is normal if you see a short white glare on your parent unit screen as the baby unit is adapting to the dark environment.
- When the infrared LEDs are on, the images are in black and white. This is normal.

TIP

- Depending on the surroundings and other interfering factors, like lightings, objects, colors and backgrounds, the video quality may vary. Adjust the baby unit's angle or place the baby unit at a higher level to prevent glare and blurry display.

MOUNT THE BABY UNIT (OPTIONAL)

Your baby monitor comes ready for tabletop use. You can also choose to mount your baby monitor on the wall. See Mount the baby unit on dry wall (optional) in the **Quick Start Guide** for the wall mounting instructions.

GENERAL PRODUCT CARE

To keep this product working well and looking good, follow these guidelines:

- Avoid putting it near heating appliances and devices that generate electrical noise (for example, motors or fluorescent lamps).
- DO NOT expose it to direct sunlight or moisture.
- Avoid dropping the product or treating it roughly.
- Clean with a soft cloth.
- DO NOT immerse the parent unit and the baby unit in water and do not clean them under the tap.
- DO NOT use cleaning spray or liquid cleaners.
- Make sure the baby unit and parent unit are dry before you connect them to the mains again.

STORAGE

When you are not going to use the baby monitor for some time, remove the rechargeable battery from the parent unit. Store the parent unit, the baby unit and the adapters in a cool and dry place.

FREQUENTLY ASKED QUESTIONS

Below are the questions most frequently asked about the baby monitor. If you cannot find the answer to your question, visit our website at www.vtechphones.com, or contact 1 (800) 595-9511 for customer service.

| | |
|---|--|
| Why does the baby monitor not respond normally? | Try the following (in the order listed) for common cause: 1. Disconnect the power to the baby units and the parent unit. 2. Remove the batteries in the parent unit. Then, install the batteries again. 3. Wait a few seconds before connecting power back to the baby units and the parent unit. 4. Turn on the baby units and the parent unit. 5. Wait for the parent unit to synchronize with the baby units. Allow up to one minute for this to take place. |
| Why don't the power-on light of the baby unit and parent unit go on when I switch on the units? | Perhaps the parent unit is not connected to the power. Insert the appliance plug into the parent unit and put the adapter in a wall socket. Then, press and hold POWER to switch on the parent unit and to establish connection with the baby unit. Perhaps the baby unit is not connected to the power. Insert the appliance plug into the baby unit and put the adapter in a wall socket. Then, slide the ON/OFF switch to ON to switch on the baby unit and to establish connection with the parent unit. |
| Why doesn't my parent unit charge while connected to AC power? | Make sure the power is not controlled by a wall switch. Make sure the battery is correctly installed in your parent unit. You may have used the battery for a long time. Replace a new battery. |
| Why is my screen in black and white? | The screen is in black and white during night-time or in a dark room when the night vision feature is activated. This is normal. |
| Why do I get glare or blurry display on my screen when viewing my baby at night? | During night-time or in a dark room, the surroundings and other interfering factors, like lightings, objects, colors and backgrounds may affect the image quality on your parent unit screen. Adjust the baby unit's angle or place the baby unit at a higher level to prevent glare and blurry display. |
| Why does the baby monitor produce a high-pitched noise? | The parent unit and baby units may be too close to each other. • Move the parent unit away from the baby units until the noise stops; OR • Turn down the volume of your parent unit. |
| Why does the parent unit beep? | The baby units may be out of range. Move the parent unit closer to the baby units (but not less than 3 feet). |
| Why does the parent unit not charge when connected to AC power? | The parent unit may not have enough charge for the parent unit to perform normally. Charge the battery in the parent unit until the battery icon becomes solid . If your parent unit is in Split mode, some of your baby units may detect sounds. The temperature of your baby's room may be too high or too low. |
| Why does the parent unit beep frequently in Split mode? | You may have set the VOX sensitivity level to Highest when the sound alert feature is turned on. The parent unit notifies you of all sounds including background noise with beeps. Adjust the VOX sensitivity to a lower level. |
| Why does the parent unit react too quickly to other sounds? | The baby unit also picks up other sounds than those of your baby. Adjust the VOX sensitivity level to a lower level or lower the parent unit speaker volume. |
| Why don't I hear a sound/ Why can't I hear my baby cry? | The parent unit speaker volume may be too low. Press VOL ● to increase the volume. You may have set a low VOX sensitivity level. See Adjust the sound sensitivity of the baby unit to set to a higher level. |
| Why can't I establish a connection lost every now and then? Why are there sound interruptions? | The baby units may be out of range. Move the parent unit closer to the baby units (but not less than 3 feet). Other electronic and wireless products may cause interference with your baby monitor. Try installing your baby monitor as far away from these devices as possible. |
| Why does the parent unit display and No link to CAM #, and the LINK LED light flashes. Press VIEW to switch to the baby unit you have powered on. | If you power on only one baby unit, your parent unit may display and No link to CAM #, and the LINK LED light flashes. Press VIEW to switch to the baby unit you have powered on. |

THE RBRC® SEAL

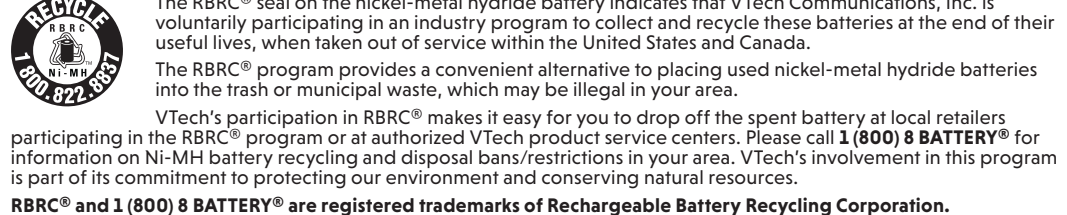

FCC AND IC REGULATIONS

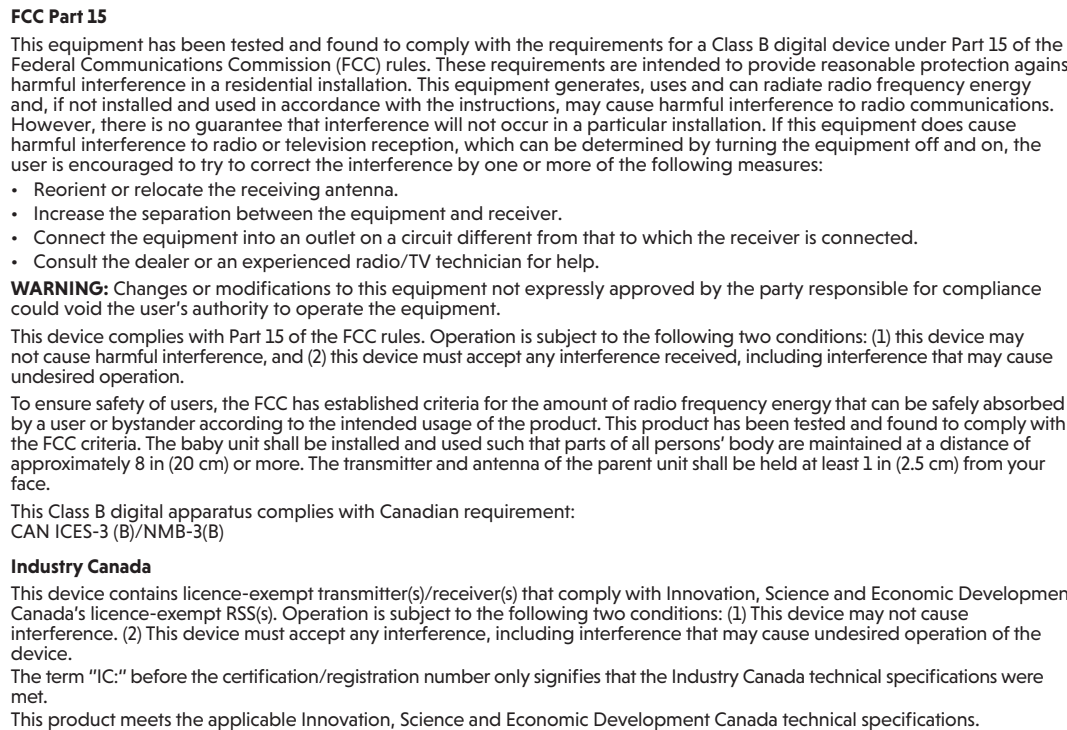

RF radiation exposure statement

The baby unit complies with FCC RF radiation exposure limits set forth for an uncontrolled environment. The baby unit should be installed and operated with a minimum distance of 8 in (20 cm) between the baby unit and all persons' body. Use of other accessories may not ensure compliance with FCC RF exposure guidelines. This transmitter must not be co-located or operating in conjunction with any other antenna or transmitter. This equipment complies also with Industry Canada RSS-102 with respect to Canada's Health Code 6 for Exposure of Humans to RF Fields.

CALIFORNIA ENERGY COMMISSION BATTERY CHARGING TESTING MODE

This baby monitor meets the California Energy Commission (CEC) regulations for energy consumption. Your baby monitor is set up to comply with the energy-conserving standards right out of the box. Follow the instructions to install and charge by battery. The CEC battery charging testing mode is activated while charging. Even if the parent unit is paired to baby units, the CEC battery charging testing mode is activated while it is powered off and charging.

FOR CETL COMPLIANCE ONLY



CONSERVER CES INSTRUCTIONS

- Mises en garde
- Utilisez et entreposez le produit à une température entre 0 ° C (32 ° F) et 40 ° C (104 ° F).
 - N'exposez pas cet appareil à des froids ou des chaleurs extrêmes, ainsi qu'à la lumière directe du soleil. Ne l'installez pas près d'une source de chaleur.
 - Le bloc-piles ne doit pas être exposé à la chaleur excessive telle que la lumière du soleil ou au feu.
 - Assurez-vous qu'il ne soit toujours hors de portée des enfants, au moins 1 mètre (3 pieds) de l'enfant ou du bébé, pour éviter tout risque de strangulation.
 - Ne jamais placer le moniteur à l'intérieur du berceau ou du parc de bébé. Ne jamais couvrir le moniteur ou l'unité (s) portative (s) d'un article tel une serviette ou une couverture.
 - D'autres équipements électroniques peuvent produire des interférences sur votre moniteur vidéo et audio. Tentez d'installer les moniteurs et câbles à l'écart des câbles de télévision, des câbles de téléphone sans fil, des téléphones cellulaires, interphones, moniteurs, téléphones, ordinateurs personnels, électromagnétiques et téléphones sans fil.

Simulateurs cardiaques implantés dans l'organisme

Les simulateurs cardiaques ne s'appliquent qu'aux dispositifs numériques sans fil:
L'organisme "Wireless Technology Research, LLC (WTR)", une firme de recherche indépendante, a mené une évaluation pluridisciplinaire des interférences entre les téléphones sans fil portatifs et les simulateurs cardiaques implantés dans l'organisme. Appuyée par l'Administration des aliments et drogues (FDA) des États-Unis, la firme WTR recommande aux utilisateurs de:

Avis aux détenteurs de simulateurs cardiaques

- Vous devriez maintenir les dispositifs sans fil à au moins six pouces du simulateur cardiaque.
- Ils ne doivent PAS placer le téléphone sans fil directement sur le simulateur cardiaque, tel que dans une poche de chemise, lorsque celui-ci est en marche.
- L'étude effectuée par l'organisme WTR n'a pas identifié de risque pour les détenteurs de simulateurs cardiaques causés par les gens qui utilisent des dispositifs sans fil à proximité de chez eux.

Champs électromagnétiques (EMF)

Ce produit de Vtech est conforme à toutes les normes se rapportant aux champs électromagnétiques (EMF) standard. Si vous le manipulez correctement en suivant les instructions de ce guide, son utilisation sera exempte de nombreux dangers, selon les meilleures évidences scientifiques dont nous disposons aujourd'hui.

LIMITED WARRANTY

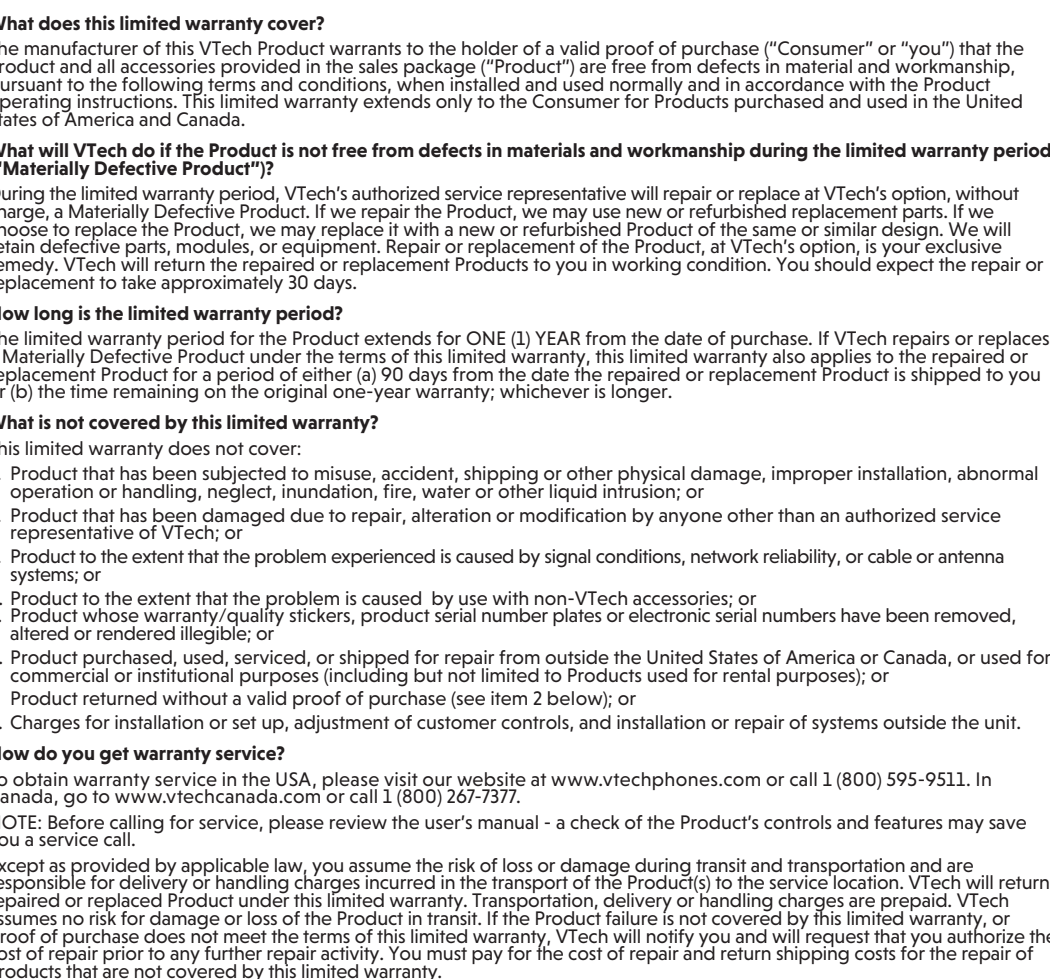

Other limitations

This warranty is the complete and exclusive agreement between you and Vtech. It supersedes all other written or oral communications, other warranties or other warranties for this Product. The warranty exclusively describes all of Vtech's responsibilities regarding the Product. There are no other express warranties. No one is authorized to make modifications to this limited warranty and you should not rely on any such modification. State/Provincial Law Rights: This warranty gives you specific legal rights, and you may also have other rights, which vary from state to state or province to province. Limitations: Implied warranties, including those of fitness for a particular purpose and merchantability (an unwritten warranty that the Product is fit for ordinary use) are limited to one year from the date of purchase. Some states/provinces do not allow limitations on how long an implied warranty lasts, so the above limitation may not apply to you. In no event shall Vtech be liable for any indirect, special, incidental, consequential, or similar damages including, but not limited to lost profit or revenue, inability to use the Product or other associated equipment, the cost of substitute equipment, and claims by third parties) resulting from the use of this Product. Some states/provinces do not allow the exclusion or limitation of incidental or consequential damages, so the above limitation or exclusion may not apply to you.

Please retain your original sales receipt as proof of purchase.